

NOTICE!!

These documents have been scanned!

Do not place un-scanned documents beneath this notice!

Do not remove this notice from this file!

GPO Jacket No. 560-102
Print Order 61540
Rise Business Services, LLC
Job=AZ15 5/14/2019



Box Number= AZ15047



Claim Begin-End: AMC415596-AMC415596

1 Initial Receipt



AZ15047-2

AMC415557-AMC416189

United States Department of the Interior
Bureau of Land Management
LANDS/RECREATION & PLANNING
ONE N CENTRAL AVE
PHOENIX, AZ 85004 -2203
Phone: 602-417-9200

Receipt

No: 2643596

Transaction #: 2724270

Date of Transaction: 08/29/2012

CUSTOMER:

CLIVE BAILEY
PO BOX 385
DRAGOON, AZ 85609-0385 US

LINE #	QTY	DESCRIPTION	REMARKS	UNIT PRICE	TOTAL
1	1.00	LOCATABLE MINERALS / MINING CLAIMS-NOT NEW-UNADJUD, ONE AUTH NO. ONLY / MINING CLAIM MONEY RECEIVED CASES: AMC415596/\$140.00	MAINT FEE PYMNT (1) 2013	- n/a -	140.00
TOTAL:					\$140.00

PAYMENT INFORMATION			
1	AMOUNT:	140.00	POSTMARKED: N/A
	TYPE:	CHECK	RECEIVED: 08/28/2012
	CHECK NO:	2319	
	NAME:	BAILEY, CLIVE PO BOX 385 DRAGOON AZ 85609-0385 US	

REMARKS

This receipt was generated by the automated BLM Collections and Billing System and is a paper representation of a portion of the official electronic record contained therein.

United States Department of the Interior

Bureau of Land Management

LANDS/RECREATION & PLANNING

ONE N CENTRAL AVE

PHOENIX, AZ 85004 -2203

Phone: 602-417-9200

Receipt

No:

2862637

Transaction #: 2948525

Date of Transaction: 08/22/2013

CUSTOMER:

CLIVE BAILEY
PO BOX 385
DRAGOON, AZ 85609-0385 US

LINE #	QTY	DESCRIPTION	REMARKS	UNIT PRICE	TOTAL
1	1.00	LOCATABLE MINERALS / MINING CLAIMS-NOT NEW-UNADJUD, ONE AUTH NO. ONLY / MINING CLAIM MONEY RECEIVED CASES: AMC415596/\$140.00	MAINT 2014/2	- n/a -	140.00
TOTAL:					\$140.00

PAYMENT INFORMATION					
1	AMOUNT:	140.00		POSTMARKED:	08/20/2013
	TYPE:	CHECK		RECEIVED:	08/22/2013
	CHECK NO:	2399			
	NAME:	BAILEY, SHIRLEY M PO BOX 385 DRAGOON AZ 85609-0385 US			

REMARKS

This receipt was generated by the automated BLM Collections and Billing System and is a paper representation of a portion of the official electronic record contained therein.

United States Department of the Interior
Bureau of Land Management
LANDS/RECREATION & PLANNING
ONE N CENTRAL AVE
PHOENIX, AZ 85004 -2203
Phone: 602-417-9200

Receipt

No:

2559037

Transaction #: 2638104

Date of Transaction: 04/30/2012

ENTERED INTO COMPUTER

CUSTOMER:

MAY 03 2012 PB

CLIVE BAILEY
PO BOX 385
DRAGOON, AZ 85609-0385 US

LINE #	QTY	DESCRIPTION	REMARKS	UNIT PRICE	TOTAL
1	1.00	LOCATABLE MINERALS / MINING CLAIMS- NEW, UNADJUD, ONE OR MORE AUTH NOS / NEW MINING CLAIM PROCESSING FEE \$15 CASES: AMC415596/\$15.00		- n/a -	15.00
2	1.00	LOCATABLE MINERALS / MINING CLAIMS- NEW, UNADJUD, ONE OR MORE AUTH NOS / NEW MINING CLAIM LOCATION FEE \$34 CASES: AMC415596/\$34.00		- n/a -	34.00
3	1.00	LOCATABLE MINERALS / MINING CLAIMS- NEW, UNADJUD, ONE OR MORE AUTH NOS / NEW MINING CLAIM MAINT FEE \$140 CASES: AMC415596/\$140.00		- n/a -	140.00
TOTAL:					\$189.00

PAYMENT INFORMATION

1	AMOUNT:	189.00	POSTMARKED:	N/A
	TYPE:	CHECK	RECEIVED:	04/30/2012
	CHECK NO:	1474		
	NAME:	BAILEY, CLIVE PO BOX 385 DRAGOON AZ 85609-0385 US		

REMARKS

This receipt was generated by the automated BLM Collections and Billing System and is a paper representation of a portion of the official electronic record contained therein.

NOTICE!!

These documents have been scanned!

Do not place un-scanned documents beneath this notice!

Do not remove this notice from this file!

GPO Jacket No. 560-102
Print Order 61540
Rise Business Services, LLC
Job=AZ15 5/14/2019



Box Number= AZ15047



Claim Begin-End: AMC415596-AMC415596

2 Correspondence



AZ15047-2

AMC415557-AMC416189

**NO
DOCUMENTS
FOUND**

NO DOCUMENTS FOUND
NO DOCUMENTS FOUND

NOTICE!!

These documents have been scanned!

Do not place un-scanned documents beneath this notice!

Do not remove this notice from this file!

GPO Jacket No. 560-102
Print Order 61540
Rise Business Services, LLC
Job=AZ15 5/14/2019



Box Number= AZ15047



Claim Begin-End: AMC415596-AMC415596

3 Transfers



AZ15047-2

AMC415557-AMC416189

**NO
DOCUMENTS
FOUND**

NO DOCUMENTS FOUND
NO DOCUMENTS FOUND

NOTICE!!

These documents have been scanned!

Do not place un-scanned documents beneath this notice!

Do not remove this notice from this file!

GPO Jacket No. 560-102
Print Order 61540
Rise Business Services, LLC
Job=AZ15 5/14/2019



Box Number= AZ15047



Claim Begin-End: AMC415596-AMC415596

4 Miscellaneous



AZ15047-2

AMC415557-AMC416189

Customer Name Update Screen

System ID:MC

Name:BAILEY CLIVE R G

Lookup

Proprietor #:2102668

Renumber To:

Category:P - PRIVATE

Address:PO BOX 385

City:DRAGOON

State:AZ

Zip:856090385

☐ UNDELIVERABLE

Address Updated
ENTERED INTO COMPUTER

MAY 03 2012 *pb*

Save

Save/Override DataFlux

Delete

Renumber

Customer details successfully saved for Customer Id 2102668

List of Proprietors
BAILEY CLIVE R G[2102668], 2763 W CATTAIL PL, , TUCSON, AZ, 85745, P,
<i>↑ Previous Address</i>

P.O. Box 385
DRAGON, AZ 85609

United States Postal Service®
DELIVERY CONFIRMATION™

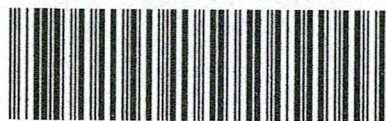

0312 0090 0002 0996 3538

RECEIVED
BLM AZ STATE OFFICE

2012 AUG 28 P 1:12

PHOENIX, ARIZONA



BLM
Arizona State Office
One North Central Ave. Suite 800
Phoenix, AZ 85004-4427

NOTICE!!

These documents have been scanned!

Do not place un-scanned documents beneath this notice!

Do not remove this notice from this file!

GPO Jacket No. 560-102
Print Order 61540
Rise Business Services, LLC
Job=AZ15 5/14/2019



Box Number= AZ15047



Claim Begin-End: AMC415596-AMC415596

5 Annual Filings



AZ15047-2

AMC415557-AMC416189

415596

UNITED STATES
DEPARTMENT OF THE INTERIOR
BUREAU OF LAND MANAGEMENT
**MAINTENANCE FEE PAYMENT FORM FOR
LODE CLAIMS, MILL SITES, AND TUNNEL SITES**

Remitter Name: Clive R. G. Bailey
Mailing Address: PO Box 385
City, State, Zip: Dragoon, AZ 85609

☐ Check here if this is a change of address.

FOR COUNTY RECORDER'S USE

No. of claims/sites 1
x \$165 per claim/site
Total due BLM \$ 165

1. The maintenance fee may be paid by cash, check, money order, Bureau of Land Management (BLM) Declining Deposit Account, or credit card (VISA, American Express, Discover, or MasterCard). Payments must be remitted to the BLM State Office where your claim or site is recorded and received on or before September 1. If the payment is mailed, the envelope must be postmarked by a bona fide delivery service on or before September 1 and received at the proper BLM State Office within 15 calendar days after the due date. Payments may also be made by telephone using a credit card. A complete listing of BLM State Offices with their addresses and phone numbers can be found at <http://www.blm.gov>.
2. The maintenance fee for the following claim(s)/site(s) applies to the assessment year 2020

CLAIM/SITE NAME	BLM SERIAL NO.
Blackwatch Fraction	AMC 415596

RECEIVED
BLM AZ STATE OFFICE
2019 AUG 12 P 2:38
PHOENIX, ARIZONA

Use a separate sheet for additional claim/site names, serial numbers, and claimant names and addresses.

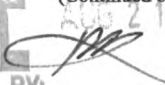
ENTERED
(Continued on page 2)
BY: 

4531988

United States Department of the Interior
Bureau of Land Management
DIV OF LANDS, MINRLS & ENERGY
ONE N CENTRAL AVE
PHOENIX, AZ 85004 -4427
Phone: 602-417-9200

Receipt	
No:	4531988

Transaction #: 4652853

Date of Transaction: 08/14/2019

CUSTOMER:

CLIVE BAILEY
PO BOX 385
DRAGOON, AZ 85609-0385 US

LINE #	QTY	DESCRIPTION	REMARKS	UNIT PRICE	TOTAL
1	1.00	LOCATABLE MINERALS / MINING CLAIMS- NOT NEW-UNADJUD, ONE AUTH NO. ONLY / MINING CLAIM MONEY RECEIVED CASES: AMC415596/\$165.00	MAINT 2020	- n/a -	165.00
TOTAL:					\$165.00

PAYMENT INFORMATION				
1	AMOUNT:	165.00	POSTMARKED:	N/A
	TYPE:	CHECK	RECEIVED:	08/12/2019
	CHECK NO:	1335		
	NAME:	BAILEY, CLIVE PO BOX 385 DRAGOON AZ 85609-0385 US		

REMARKS

This receipt was generated by the automated BLM Collections and Billing System and is a paper representation of a portion of the official electronic record contained therein.

415596

UNITED STATES
DEPARTMENT OF THE INTERIOR
BUREAU OF LAND MANAGEMENT
**MAINTENANCE FEE PAYMENT FORM FOR
LODE CLAIMS, MILL SITES, AND TUNNEL SITES**

Remitter Name: Clive R. G. Bailey
Mailing Address: PO Box 385
City, State, Zip: Dragoon, AZ 85609

☐ Check here if this is a change of address.

FOR COUNTY RECORDER'S USE

No. of claims/sites 1
x \$165 per claim/site
Total due BLM \$ 165

1. The maintenance fee may be paid by cash, check, money order, Bureau of Land Management (BLM) Declining Deposit Account, or credit card (VISA, American Express, Discover, or MasterCard). Payments must be remitted to the BLM State Office where your claim or site is recorded and received on or before September 1. If the payment is mailed, the envelope must be postmarked by a bona fide delivery service on or before September 1 and received at the proper BLM State Office within 15 calendar days after the due date. Payments may also be made by telephone using a credit card. A complete listing of BLM State Offices with their addresses and phone numbers can be found at <http://www.blm.gov>.
2. The maintenance fee for the following claim(s)/site(s) applies to the assessment year 2020

CLAIM/SITE NAME	BLM SERIAL NO.
Blackwatch Fraction	AMC 415596

RECEIVED
BLM AZ STATE OFFICE
2019 AUG 12 P 2:38
PHOENIX, ARIZONA

Use a separate sheet for additional claim/site names, serial numbers, and claimant names and addresses.

ENTERED
(Continued on page 2)
BY: [Signature]

4531988

United States Department of the Interior
Bureau of Land Management
DIV OF LANDS, MINRLS & ENERGY
ONE N CENTRAL AVE
PHOENIX, AZ 85004 -4427
Phone: 602-417-9200

Receipt	
No:	4531988

Transaction #: 4652853

Date of Transaction: 08/14/2019

CUSTOMER:

CLIVE BAILEY
PO BOX 385
DRAGOON, AZ 85609-0385 US

LINE #	QTY	DESCRIPTION	REMARKS	UNIT PRICE	TOTAL
1	1.00	LOCATABLE MINERALS / MINING CLAIMS- NOT NEW-UNADJUD, ONE AUTH NO. ONLY / MINING CLAIM MONEY RECEIVED CASES: AMC415596/\$165.00	MAINT 2020	- n/a -	165.00
TOTAL:					\$165.00

PAYMENT INFORMATION				
1	AMOUNT:	165.00	POSTMARKED:	N/A
	TYPE:	CHECK	RECEIVED:	08/12/2019
	CHECK NO:	1335		
	NAME:	BAILEY, CLIVE PO BOX 385 DRAGOON AZ 85609-0385 US		

REMARKS

This receipt was generated by the automated BLM Collections and Billing System and is a paper representation of a portion of the official electronic record contained therein.

429559

447887

415596

NOTICE OF INTENTION TO HOLD MINING CLAIMS/SITES

When Recorded Return Document to:

Clive Bailey
P.O. Box 385
Dracon, AZ 85609

BLM
Date
Stamp

RECEIVED
BLM AZ STATE OFFICE
2018 DEC 14 P 2:41
PHOENIX, ARIZONA

☐ Check here if this is a change of address.

Telephone: (520) 360-4936

E-mail Address: edge 49 tos@gmail.com

I (We) intend to hold the claims(s) and/or site(s) listed below for the calendar year 2019, and I (We) have filed or will file a Notice of Intent to Hold in the county where the claim (s) is located.

Reason for filing a Notice of Intent to Hold instead of an assessment work filing (check one):

- * ☒ Maintenance fee was paid to maintain claim(s) during this assessment year. TRANS 4356917 8-22-18
☐ Mill or tunnel sites.
☐ Claim(s) was located during the current assessment year.
☒ BLM has deferred assessment work (attach copy of decision granting deferment, or pending petition for deferment including date petition was filed.) Alpha Omega Small Miner # 4241504 8-21-18

Line No.	AMC NUMBER	CLAIM/SITE NAME	COUNTY RECORDER DATA (If available)	TWP	RNG	SEC
1	429562	Alpha Omega #77	2014-20589	16S	23E	4
2	447888	Alpha Omega #76	2014-20588	16S	23E	4
3	447889	Alpha Omega #65	2014-00587	16S	23E	4
4	447890	Alpha Omega #64	2014-20586	16S	23E	4
5*	415596	Blackwatch Frac.	2012-10607	16S	22E	13
6						
7						
8						
9						
10						

4336456

Form: MCF110

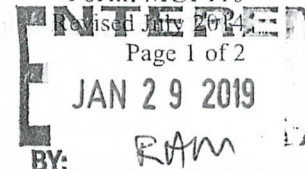

NOTICE OF INTENTION TO HOLD MINING CLAIMS/SITES
page 2

RECEIVED BLM AZ STATE OFFICE 2018 DEC 14 P 2:41 PHOENIX, ARIZONA	BLM Date Stamp
---	----------------------

1. State of Arizona, County of Cochise
2. I (Name) Clive R. G. Bailey
3. Reside at (Address) 4528 E. Sacred Roak Road, P.O. Box 385
City Dragoon County Cochise State AZ Zip 85609 being duly sworn, depose and
say that I am a citizen of the United States, more than eighteen years of age, that all of the facts set forth in this
notice, subject to the provisions and penalties of 18 U.S.C. 1001 pertaining to the filing of false, fictitious, or fraudulent
statements with the United States, are true and correct according to the best of my knowledge, information and belief.
4. Owner's name and address (If not shown in Items 1-3 above). _____
5. Dated: 10-23-18 Signature: Clive R. G. Bailey

Bureau of Land Management
Arizona State Office
www.az.blm.gov

No. of Claims: _____ x \$10 = _____
Check No: _____ Init. _____
Receipt No.: _____
For BLM Use Only

Form: MCF110
Revised Jan. 2006
Page 2 of 2

This form is available from the Arizona Department of Mines & Mineral Resources and may be reproduced.

P.O. Box 385
DRAGON, AZ 85609



**United States Department of the Interior
Bureau of Land Management**

DIV OF LANDS, MINRLS & ENERGY
ONE N CENTRAL AVE
PHOENIX, AZ 85004 -4427
Phone: 602-417-9200

RECEIVED
BLM AZ STATE OFFICE
2018 DEC 14 P 2:41
PHOENIX, ARIZONA

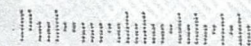

P.O. Box 385
DRAGON, AZ 85609



United States Department of the Interior
Bureau of Land Management
DIV OF LANDS, MINRLS & ENERGY
ONE N CENTRAL AVE
PHOENIX, AZ 85004 -4427
Phone: 602-417-9200

RECEIVED
BLM AZ STATE OFFICE
2018 DEC 14 P 2:41
PHOENIX, ARIZONA



United States Department of the Interior
Bureau of Land Management
DIV OF LANDS, MINRLS & ENERGY
ONE N CENTRAL AVE
PHOENIX, AZ 85004 -4427
Phone: 602-417-9200

Receipt

No: 4336456

Transaction #: 4453234	
Date of Transaction: 12/17/2018	
CUSTOMER:	
	CLIVE BAILEY PO BOX 385 DRAGOON, AZ 85609-0385 US

LINE #	QTY	DESCRIPTION	REMARKS	UNIT PRICE	TOTAL
1	1.00	LOCATABLE MINERALS / MINING CLAIMS- NOT NEW-UNADJUD, ONE AUTH NO. ONLY / MINING CLAIM MONEY RECEIVED CASES: AMC429562/\$75.00	POL 2018/5	- n/a -	75.00
TOTAL:					\$75.00

PAYMENT INFORMATION				
1	AMOUNT:	75.00	POSTMARKED:	N/A
	TYPE:	CHECK	RECEIVED:	12/14/2018
	CHECK NO:	1294		
	NAME:	BAILEY, CLIVE PO BOX 385 DRAGOON AZ 85609-0385 US		

REMARKS

This receipt was generated by the automated BLM Collections and Billing System and is a paper representation of a portion of the official electronic record contained therein.

UNITED STATES
DEPARTMENT OF THE INTERIOR
BUREAU OF LAND MANAGEMENT
**MAINTENANCE FEE PAYMENT FORM FOR
LODE CLAIMS, MILL SITES, AND TUNNEL SITES**

415596

Remitter Name: Clive R. G. Bailey
Mailing Address: P.O. Box 385
City, State, Zip: Draagoon, AZ 85609

☐ Check here if this is a change of address.

FOR COUNTY RECORDER'S USE

No. of claims/sites 1
x \$155 per claim/site
Total due BLM \$ \$ 155

1. The maintenance fee may be paid by cash, check, money order, Bureau of Land Management (BLM) Declining Deposit Account, or credit card (VISA, American Express, Discover, or MasterCard). Payments must be remitted to the BLM State Office where your claim or site is recorded and received on or before September 1. If the payment is mailed, the envelope must be postmarked by a bona fide delivery service on or before September 1 and received at the proper BLM State Office within 15 calendar days after the due date. Payments may also be made by telephone using a credit card. A complete listing of BLM State Offices with their addresses and phone numbers can be found at <http://www.blm.gov>.
2. The maintenance fee for the following claim(s)/site(s) applies to the assessment year 2019

CLAIM/SITE NAME	BLM SERIAL NO.
Blackwatch Fraction	AMC 415596

RECEIVED
BLM AZ STATE OFFICE
2018 AUG 21 P 2:06
PHOENIX, ARIZONA

Use a separate sheet for additional claim/site names, serial numbers, and claimant names and addresses.

(Continued on page 2)

4241504 ENTERED
AUG 27 2018
BY: RIM

INSTRUCTIONS

1. This is an optional form that may be used to satisfy the requirements for the Bureau of Land Management (BLM) under the provisions of 43 U.S.C. §1744 and 30 U.S.C. §28f and the regulations thereunder (43 CFR part 3834). Since local and State laws may vary, you should contact your local and State agencies where the claims are located to ensure all applicable laws and requirements are satisfied.
2. This form should be used to pay the maintenance fee for lode mining claims, mill sites, and tunnel sites only. To pay the maintenance fee for placer mining claims, use Form 3830-5a.
3. Complete the section for the number of claims and the amount being remitted to the BLM.
4. Enter the year in paragraph 2 for the applicable assessment year.
5. List all mining claim or site names and the BLM serial number associated to the claim or site, if the BLM has notified you what the serial number is. Every attempt should be made to include the current BLM serial number for each claim or site listed.
6. The name and current mailing addresses of the person paying the maintenance fee(s) should be listed at the top of the form. If this is a change of address for a claimant, that should also be noted.
7. If needed, an additional sheet can be used to continue listing claim and site names and BLM serial numbers, or the name and current mailing address of additional claimants.
8. If paying by credit card, you must complete the following credit card information on page 3: (a) exact name on the face of the credit card; (b) amount paid; (c) type of card; (d) credit card number; (e) expiration date of the card; and (f) telephone number. You must also sign on page 3 to show authorization to charge the credit card.

NOTICES

THE PRIVACY ACT and 43 CFR 2.48(d) require that you be furnished with the following information in connection with the information requested by this form.

AUTHORITY: 30 U.S.C. 28f and 43 CFR part 3834 permit collection of the information requested by this form.

PRINCIPAL PURPOSE: The BLM will use the information you provide to record the annual maintenance fee payment for the claims and sites listed and to verify that payment has been made in accordance with 30 U.S.C. 28f and 43 CFR part 3834.

ROUTINE USES: The BLM will only disclose this information in accordance with the provisions at 43 CFR 2.56(b) and (c).

EFFECT OF NOT PROVIDING INFORMATION: Disclosure of the requested information is required by 30 U.S.C. 28f and 43 CFR part 3834 for claimants paying the annual maintenance fee. The use of this specific form when paying the maintenance fee is optional. However, when paying the maintenance fee, it is the requested information on this form that is required to be submitted along with the fee. Failure to submit all the required information will delay the BLM's processing of the information and may preclude the BLM's acceptance of the maintenance fee payment, which may result in forfeiture of the mining claim(s) or site(s) by the claimant.

United States Department of the Interior
Bureau of Land Management
 DIV OF LANDS, MINRLS & ENERGY
 ONE N CENTRAL AVE
 PHOENIX, AZ 85004 -4427
 Phone: 602-417-9200

Receipt

No: 4241504

Transaction #: 4356917	
Date of Transaction: 08/22/2018	
CUSTOMER:	
	CLIVE BAILEY PO BOX 385 DRAGON, AZ 85609-0385 US

LINE #	QTY	DESCRIPTION	REMARKS	UNIT PRICE	TOTAL
1	1.00	LOCATABLE MINERALS / MINING CLAIMS-NOT NEW-UNADJUD, ONE AUTH NO. ONLY / MINING CLAIM MONEY RECEIVED CASES: AMC429559/\$195.00	POL 2018/4 WAV MAINT 2019/1	- n/a -	195.00
TOTAL:					\$195.00

PAYMENT INFORMATION			
1	AMOUNT:	155.00	POSTMARKED: N/A
	TYPE:	CHECK	RECEIVED: 08/21/2018
	CHECK NO:	1266	
	NAME:	BAILEY, CLIVE PO BOX 385 DRAGON AZ 85609-0385 US	
2	AMOUNT:	40.00	POSTMARKED: N/A
	TYPE:	CHECK	RECEIVED: 08/21/2018
	CHECK NO:	1267	
	NAME:	BAILEY, CLIVE PO BOX 385 DRAGON AZ 85609-0385 US	

REMARKS
PLEASE ONLY SEND ONE COPY OF THE AFFIDAVIT ONLY/EITHER FORM WILL WORK/ THANK YOU

This receipt was generated by the automated BLM Collections and Billing System and is a paper representation of a portion of the official electronic record contained therein.

AFFIDAVIT OF ANNUAL ASSESSMENT WORK

AMC 429559
415596

WHEN RECORDED, MAIL DOCUMENT TO:

NAME: Clive R. G. Bailey

ADDRESS: P.O. Box 385

CITY, STATE, ZIP: Dragoon, AZ 85609

FOR COUNTY RECORDER'S USE

No. of Claims 4

x \$10/claim

Total due BLM \$ 40.00

TO ALL WHOM IT MAY CONCERN:

1. The undersigned certifies that at least \$100 per claim was expended for development, labor and improvements, or equivalent value added, as the annual assessment work for the assessment year ending September 1, 2017 for the following contiguous unpatented mining claim(s), located in the County of Cochise, in the State of Arizona.

BLM Serial No.	Name of Claim	Tp	Rg	Sec	Mer	County Recordation Book and Page No.	Date
AMC 429559	Alpha Omega #64	16 S	23 E	4	GSR	2014-20586	11-19-14
AMC 429560	Alpha Omega #65	16 S	23 E	4	GSR	2014-20587	11-19-14
AMC 429561	Alpha Omega #76	16 S	23 E	4	GSR	2014-20588	11-19-14
AMC 429562	Alpha Omega #77	16 S	23 E	4	GSR	2014-20589	11-19-14

RECEIVED
BLM AZ STATE OFFICE
2017 DEC 20 P 2:44
PHOENIX, ARIZONA

(Continued on page 2)

ENTERED
DEC 20 2017
BY: fr

2. Type of labor and improvements (specify what was done and give the total value for that labor and improvement to show at least \$100 for each claim). If a geological, geochemical, or geophysical survey was performed, as per 30 U.S.C. 28-1, reference the title of the report of survey, give cost and date of the survey and report, and indicate it was filed with the County Recorder:

Description of Work Performed	Value of Work Performed	Date Work Was Performed
CABLE & WOOD LADDERS BUILT AND TAKEN TO SITE	\$ 320	JAN-FEB 2017
44' WOOD LADDERS INSTALLED 1 st to 2 nd level bypass		6-23-17
52' CABLE LADDERS INSTALLED FROM 4 th level down	\$ 350	
	\$ 670	

3. Name and mailing address of each person who performed the labor and improvements:

Name (please print)
ROLF LUTCKE

Current Mailing Address (please print)
1313 N. Highway 80 St. David, AZ 85630-9706

RON, JONATHAN, JOSEPH
MARTENS

13497 S. Bell, Benson, AZ 85602

4. Name and mailing address of each person who holds and claims the subject mining claim(s) for the valuable minerals contained therein. Be sure to indicate if there is a change of address:

Name (please print)
Clive R. G. Bailey

Current Mailing Address (please print)
P.O. Box 385 Dragoon, AZ 85609

RECEIVED
ALMA MATER OFFICE
2017 DEC 20 P 2:44
PHOENIX, ARIZONA

5. The undersigned testifies that on the date of September 1, 2017, all monuments required by law were erected upon the subject claim(s), and all notices required by law were posted on the subject claim(s) or copies thereof were in place, and at said date, each corner monument bore or contained

markings sufficient to appropriately designate the corner of the claim to which it pertains and the name of the claim(s).

I hereby certify under penalty of perjury under the laws of the State of Arizona that the foregoing statements are true and correct:

Chi PY Bui

Date: Dec. 15, 2017

(Signature of person responsible for above statement)

Title 18 U.S.C. 1001 and 43 U.S.C. 1212 make it a crime for any person knowingly and willfully to make to any department or agency of the United States any false, fictitious or fraudulent statements or representations as to any matter within its jurisdiction.

Notary Block

SUBSCRIBED AND SWORN TO before me, this 15 day of December 2017

By: [Signature]
(Signature of Affiant)

Title: Notary Public

My Commission Expires: Sept 25, 2019

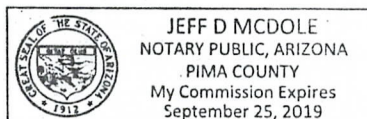

INSTRUCTIONS

1. This is an optional form that may be used to satisfy the requirements for the Bureau of Land Management (BLM) under the provisions of 43 U.S.C. §1744 and 30 U.S.C. §28-28d and the regulations thereunder (43 CFR part 3835). Since local and State laws may vary, you should contact your local and State agencies where the claims are located to ensure all applicable laws and requirements are satisfied.
2. The claimant(s) must fill in the date in paragraph 1 for the applicable assessment year and the county and state where the claims are located.
3. All claim names, BLM serial numbers, legal descriptions, and original county recording information must be listed for the claims pertaining to this assessment notice.
4. The claimant(s) must complete paragraph 2 listing all labor or improvements which was performed on or did benefit the subject mining claims. The value and date of the labor or improvements must also be listed. The total amount of labor or improvements can be listed, but the total expenditure must equal at least \$100 for each claim.
5. The names and current mailing addresses of the person(s) performing the labor shall be listed in paragraph 3.
6. The name and current mailing address of each owner (claimant) of the claims shall be listed in paragraph 4. The mailing address shall be the owner's address and not the address of an agent or anyone representing the claimant. Be sure to note if there has been a change of address.
7. Paragraph 5 shall be completed to show the date it was verified that all monuments required by law were properly erected, all notices were posted, and that corners were appropriately designated for all claims listed.
8. An exact legible reproduction or duplicate (other than microfilm or other electronic media) of this affidavit or another type of affidavit of assessment work that you file or will file in the county where each claim is located, must be filed with the BLM on or before December 30 of the calendar year in which the assessment year ends. For mill or tunnel sites, a separate notice of intent to hold must be filed with the BLM on or before December 30. Requirements for filing a notice of intent to hold can be found at 43 CFR 3835.33.
9. A processing fee of \$10 for each claim listed must be remitted to the BLM along with this or any other affidavit of assessment work.

(Continued on page 4)

(Form 3830-4, page 3)

RECEIVED
BLM STATE OFFICE
2017 DEC 20 P 2:44
PHOENIX, ARIZONA

UNITED STATES
DEPARTMENT OF THE INTERIOR
BUREAU OF LAND MANAGEMENT
**MAINTENANCE FEE PAYMENT FORM FOR
LODE CLAIMS, MILL SITES, AND TUNNEL SITES**

Remitter Name: Clive R.G. Bailey

Mailing Address: PO Box 385

City, State, Zip: Dragoon, AZ 85609

☐ Check here if this is a change of address.

FOR COUNTY RECORDER'S USE

No. of claims/sites 5

x \$155 per claim/site

Total due BLM \$ 775

1. The maintenance fee may be paid by cash, check, money order, Bureau of Land Management (BLM) Declining Deposit Account, or credit card (VISA, American Express, Discover, or MasterCard). Payments must be remitted to the BLM State Office where your claim or site is recorded and received on or before September 1. If the payment is mailed, the envelope must be postmarked by a bona fide delivery service on or before September 1 and received at the proper BLM State Office within 15 calendar days after the due date. Payments may also be made by telephone using a credit card. A complete listing of BLM State Offices with their addresses and phone numbers can be found at <http://www.blm.gov>.

2. The maintenance fee for the following claim(s)/site(s) applies to the assessment year 2018

CLAIM/SITE NAME	BLM SERIAL NO.
Blackwatch Fraction	AMC 415596
Alpha Omega #64	AMC 429559
Alpha Omega #65	AMC 429560
Alpha Omega #76	AMC 429561
Alpha Omega #77	AMC 429562

Use a separate sheet for additional claim/site names, serial numbers, and claimant names and addresses.

(Continued on page 2)

RECEIPT # 3919200

United States Department of the Interior
Bureau of Land Management
DIV OF LANDS, MINRLS & ENERGY
ONE N CENTRAL AVE
PHOENIX, AZ 85004 -4427
Phone: 602-417-9200

Receipt

No:

3919200

Transaction #: 4028684

Date of Transaction: 08/03/2017

CUSTOMER:

CLIVE BAILEY
PO BOX 385
DRAGOON, AZ 85609-0385 US

LINE #	QTY	DESCRIPTION	REMARKS	UNIT PRICE	TOTAL
1	1.00	LOCATABLE MINERALS / MINING CLAIMS- NOT NEW-UNADJUD, ONE AUTH NO. ONLY / MINING CLAIM MONEY RECEIVED CASES: AMC415596/\$775.00	MAINT FEE 2018 (5)	- n/a -	775.00
TOTAL:					\$775.00

PAYMENT INFORMATION

1	AMOUNT:	775.00	POSTMARKED:	N/A
	TYPE:	CHECK	RECEIVED:	08/03/2017
	CHECK NO:	1168		
	NAME:	BAILEY, CLIVE PO BOX 385 DRAGOON AZ 85609-0385 US		

REMARKS

This receipt was generated by the automated BLM Collections and Billing System and is a paper representation of a portion of the official electronic record contained therein.

RECEIVED
BLM AZ STATE OFFICE
2017 DEC 20 P 2:44
PHOENIX, ARIZONA

P
D

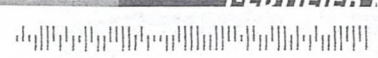

7016 3560 0000 5407 0033



1013



85004

U.S. POSTAGE
PAID
BENSON, AZ
85602
DEC 15 17
AMOUNT

\$4.54
R2304W120978-12

2017 DEC 20 P 2:44
PHOENIX, ARIZONA

Attn: ReAnn Myers Land Law Examiner

United States Department of the Interior
Bureau of Land Management
DIV OF LANDS, MINRLS & ENERGY
ONE N CENTRAL AVE
PHOENIX, AZ 85004 -4427
Phone: 602-417-9200

NOTICE OF INTENTION TO HOLD MINING CLAIMS/SITES

When Recorded Return Document to:

Clive BaileyP.O. Box 385Dragoon, AZ 85609☐ Check here if this is a change of address.Telephone: (520) 586-2408E-mail Address: edge49tos@gmail.comBLM
Date
Stamp

PHOENIX, ARIZONA

2017 DEC - 8 P 3:13

RECEIVED
BLM AZ STATE OFFICE

I (We) intend to hold the claims(s) and/or site(s) listed below for the calendar year 2017-18, and I (We) have filed or will file a Notice of Intent to Hold in the county where the claim (s) is located.

Reason for filing a Notice of Intent to Hold instead of an assessment work filing (check one):

- ☒ Maintenance fee was paid to maintain claim(s) during this assessment year.
☐ Mill or tunnel sites.
☐ Claim(s) was located during the current assessment year.
☐ BLM has deferred assessment work (attach copy of decision granting deferment, or pending petition for deferment including date petition was filed.)

Line No.	AMC NUMBER	CLAIM/SITE NAME	COUNTY RECORDER DATA (If available)	TWP	RNG	SEC
1	429559	Alpha Omega #64	2014-20586	16S	23E	4
2	429560	Alpha Omega #65	2014-20587	16S	23E	4
3	429561	Alpha Omega #76	2014-20588	16S	23E	4
4	429562	Alpha Omega #77	2014-20589	16S	23E	4
5						
6						
7						
8						
9						
10						

4039050

BLM Date Stamp	RECEIVED BLM AZ STATE OFFICE 2017 DEC - 8 P 3:13 PHOENIX, ARIZONA
----------------------	--

1. State of Arizona, County of Cochise
2. I (Name) Clive R. G. Bailey
3. Reside at (Address) 4528 E. Sacred Rock Rd. (P.O. Box 385)
City Dragoon County Cochise State AZ Zip 85609 being duly sworn, depose and
say that I am a citizen of the United States, more than eighteen years of age, that all of the facts set forth in this
notice, subject to the provisions and penalties of 18 U.S.C. 1001 pertaining to the filing of false, fictitious, or fraudulent
statements with the United States, are true and correct according to the best of my knowledge, information and belief.
4. Owner's name and address (If not shown in Items 1-3 above). _____
5. Dated: 12/3/17 Signature: Cl. R. G. Bailey

Bureau of Land Management
Arizona State Office
www.blm.gov/az

No. of Claims: _____ x \$10 = _____
Check No: _____ Init. _____
Receipt No.: _____
For BLM Use Only

UNITED STATES
DEPARTMENT OF THE INTERIOR
BUREAU OF LAND MANAGEMENT
**MAINTENANCE FEE PAYMENT FORM FOR
LODE CLAIMS, MILL SITES, AND TUNNEL SITES**

Remitter Name: Clive R.G. Bailey

Mailing Address: PO Box 385

City, State, Zip: Dragoon, AZ 85609

☐ Check here if this is a change of address.

FOR COUNTY RECORDER'S USE

No. of claims/sites 5

x \$155 per claim/site

Total due BLM \$ 775

1. The maintenance fee may be paid by cash, check, money order, Bureau of Land Management (BLM) Declining Deposit Account, or credit card (VISA, American Express, Discover, or MasterCard). Payments must be remitted to the BLM State Office where your claim or site is recorded and received on or before September 1. If the payment is mailed, the envelope must be postmarked by a bona fide delivery service on or before September 1 and received at the proper BLM State Office within 15 calendar days after the due date. Payments may also be made by telephone using a credit card. A complete listing of BLM State Offices with their addresses and phone numbers can be found at <http://www.blm.gov>.

2. The maintenance fee for the following claim(s)/site(s) applies to the assessment year 2018

CLAIM/SITE NAME	BLM SERIAL NO.
Blackwatch Fraction	AMC 415596
Alpha Omega #64	AMC 429559
Alpha Omega #65	AMC 429560
Alpha Omega #76	AMC 429561
Alpha Omega #77	AMC 429562

Use a separate sheet for additional claim/site names, serial numbers, and claimant names and addresses.

(Continued on page 2)

RECEIPT # 3919200

NOTICE OF INTENTION TO HOLD MINING CLAIMS/SITES

When Recorded Return Document to:

Clive Bailey
P.O. Box 385
Dragoon, AZ 85609

BLM
Date
StampRECEIVED
BLM AZ STATE OFFICE
2017 DEC - 8 P 3:14
PHOENIX, ARIZONA☐ Check here if this is a change of address.Telephone: (520) 586-2408E-mail Address: edge49tos@gmail.com

I (We) intend to hold the claims(s) and/or site(s) listed below for the calendar year 2017-18, and I (We) have filed or will file a Notice of Intent to Hold in the county where the claim (s) is located.

Reason for filing a Notice of Intent to Hold instead of an assessment work filing (check one):

- ☒ Maintenance fee was paid to maintain claim(s) during this assessment year.
☐ Mill or tunnel sites.
☐ Claim(s) was located during the current assessment year.
☐ BLM has deferred assessment work (attach copy of decision granting deferment, or pending petition for deferment including date petition was filed.)

Line No.	AMC NUMBER	CLAIM/SITE NAME	COUNTY RECORDER DATA (If available)	TWP	RNG	SEC
1	415596	Blackwatch Fraction	2012-10607	16S	22E	13
2						
3						
4						
5						
6						
7						
8						
9						
10						

ENTERED
DEC 20 2017
BY: Rv

Form: MCF110
Revised July 2014
Page 1 of 2

NOTICE OF INTENTION TO HOLD MINING CLAIMS/SITES
page 2

BLM Date Stamp	RECEIVED BLM AZ STATE OFFICE 2017 DEC -8 P 3:14 PHOENIX, ARIZONA
----------------------	---

1. State of Arizona, County of Cochise
2. I (Name) Clive R. G. Bailey
3. Reside at (Address) 4528 E. Sared Rock Road P.O. Box 385
City Dragoon County Cochise State AZ Zip 85609 being duly sworn, depose and
say that I am a citizen of the United States, more than eighteen years of age, that all of the facts set forth in this
notice, subject to the provisions and penalties of 18 U.S.C. 1001 pertaining to the filing of false, fictitious, or fraudulent
statements with the United States, are true and correct according to the best of my knowledge, information and belief.
4. Owner's name and address (If not shown in Items 1-3 above). _____
5. Dated: 12/3/17 Signature: Clive R. G. Bailey

Bureau of Land Management
Arizona State Office
www.blm.gov/az

No. of Claims: _____ x \$10 = _____
Check No: _____ Init. _____
Receipt No.: _____
For BLM Use Only

Form: MCF110
Revised July 2014
Page 2 of 2

This form is available from the **Arizona Geological Survey** and may be reproduced.

UNITED STATES
DEPARTMENT OF THE INTERIOR
BUREAU OF LAND MANAGEMENT
**MAINTENANCE FEE PAYMENT FORM FOR
LODE CLAIMS, MILL SITES, AND TUNNEL SITES**

Remitter Name: Clive R.G. Bailey

Mailing Address: PO Box 385

City, State, Zip: Draagoon, AZ 85609

☐ Check here if this is a change of address.

FOR COUNTY RECORDER'S USE

No. of claims/sites 5

x \$155 per claim/site

Total due BLM \$ 775

1. The maintenance fee may be paid by cash, check, money order, Bureau of Land Management (BLM) Declining Deposit Account, or credit card (VISA, American Express, Discover, or MasterCard). Payments must be remitted to the BLM State Office where your claim or site is recorded and received on or before September 1. If the payment is mailed, the envelope must be postmarked by a bona fide delivery service on or before September 1 and received at the proper BLM State Office within 15 calendar days after the due date. Payments may also be made by telephone using a credit card. A complete listing of BLM State Offices with their addresses and phone numbers can be found at <http://www.blm.gov>.

2. The maintenance fee for the following claim(s)/site(s) applies to the assessment year 2018

CLAIM/SITE NAME	BLM SERIAL NO.
Blackwatch Fraction	AMC 415596
Alpha Omega #64	AMC 429559
Alpha Omega #65	AMC 429560
Alpha Omega #76	AMC 429561
Alpha Omega #77	AMC 429562

Use a separate sheet for additional claim/site names, serial numbers, and claimant names and addresses.

(Continued on page 2)

RECEIPT # 3919200

CLIVE BAILEY
PO BOX 385
DRAGOON, AZ 85609-0385

RECEIVED
BLM / STATE OFFICE

2011 DEC -8 P 3:13

PHOENIX, ARIZONA



1013



85004

U.S. POSTAGE
PAID
DRAGOON, AZ
85609
DEC 04, 17
AMOUNT
\$1.19
R2304W119780-05

United States Department of the Interior
Bureau of Land Management
DIV OF LANDS, MINRLS & ENERGY
ONE N CENTRAL AVE
PHOENIX, AZ 85004 -4427
Phone: 602-417-9200

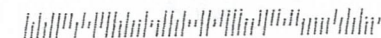

United States Department of the Interior**Bureau of Land Management**

DIV OF LANDS, MINRLS & ENERGY

ONE N CENTRAL AVE

PHOENIX, AZ 85004 -4427

Phone: 602-417-9200

Receipt

No:

4039050

Transaction #: 4150247**Date of Transaction:** 12/11/2017**CUSTOMER:**

CLIVE BAILEY

PO BOX 385

DRAGOON, AZ 85609-0385 US

LINE #	QTY	DESCRIPTION	REMARKS	UNIT PRICE	TOTAL
1	1.00	LOCATABLE MINERALS / MINING CLAIMS- NOT NEW-UNADJUD, ONE AUTH NO. ONLY / MINING CLAIM MONEY RECEIVED CASES: AMC415596/\$50.00	NOI 2017/5	- n/a -	50.00
TOTAL:					\$50.00

PAYMENT INFORMATION					
1	AMOUNT:	10.00	POSTMARKED:	N/A	
	TYPE:	CHECK	RECEIVED:	12/08/2017	
	CHECK NO:	1203			
	NAME:	BAILEY, CLIVE PO BOX 385 DRAGOON AZ 85609-0385 US			
2	AMOUNT:	40.00	POSTMARKED:	N/A	
	TYPE:	CHECK	RECEIVED:	12/08/2017	
	CHECK NO:	1204			
	NAME:	BAILEY, CLIVE PO BOX 385 DRAGOON AZ 85609-0385 US			

REMARKS

This receipt was generated by the automated BLM Collections and Billing System and is a paper representation of a portion of the official electronic record contained therein.

UNITED STATES
DEPARTMENT OF THE INTERIOR
BUREAU OF LAND MANAGEMENT
**MAINTENANCE FEE PAYMENT FORM FOR
LODE CLAIMS, MILL SITES, AND TUNNEL SITES**

415596

429559

Remitter Name: Clive R.G.Bailey
Mailing Address: PO Box 385
City, State, Zip: Dragoon, AZ 85609

☐ Check here if this is a change of address.

FOR COUNTY RECORDER'S USE

No. of claims/sites 5
x \$155 per claim/site
Total due BLM \$ 775

1. The maintenance fee may be paid by cash, check, money order, Bureau of Land Management (BLM) Declining Deposit Account, or credit card (VISA, American Express, Discover, or MasterCard). Payments must be remitted to the BLM State Office where your claim or site is recorded and received on or before September 1. If the payment is mailed, the envelope must be postmarked by a bona fide delivery service on or before September 1 and received at the proper BLM State Office within 15 calendar days after the due date. Payments may also be made by telephone using a credit card. A complete listing of BLM State Offices with their addresses and phone numbers can be found at <http://www.blm.gov>.
2. The maintenance fee for the following claim(s)/site(s) applies to the assessment year 2018.

CLAIM/SITE NAME	BLM SERIAL NO.
Blackwatch Fraction	AMC 415596
Alpha Omega #64	AMC 429559
Alpha Omega #65	AMC 429560
Alpha Omega #76	AMC 429561
Alpha Omega #77	AMC 429562

Use a separate sheet for additional claim/site names, serial numbers, and claimant names and addresses.

(Continued on page 2)

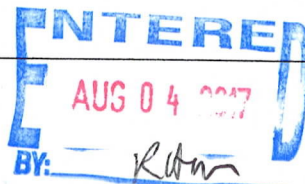

RECEIPT # 3919200

P.O. BOX 385
DRAGON, AZ 85609

BUREAU OF LAND-MANAGEMENT
1 NORTH CENTRAL AVE #800
PHOENIX, AZ 85004

MINING CLAIMS SECTION

PHOENIX, ARIZONA

2017 AUG -2 P 3:13

RECEIVED
BLM AUSTIN OFFICE



UNITED STATES POSTAL SERVICE®

Apply Priority Mail Postage



1006

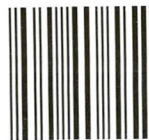

85004

U.S. POSTAGE
PAID
DRAGON, AZ
85609
AUG 01 17
AMOUNT

\$6.65

R2304W119780-05

Expected Delivery Day: 08/03/2017

USPS TRACKING NUMBER

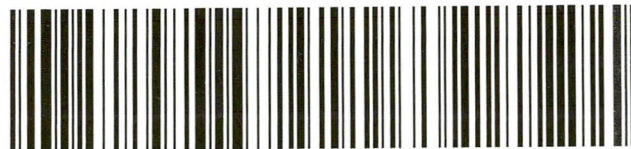

9505 5122 3271 7213 0108 53

This product is for use with Priority Mail®
supplies. Please may be a violation of
federal law. This code is not for resale.

UNITED STATES L S

Visit us at usps

Label 106 May 20



This product is for use with Priority Mail® shipments. Misuse may be a violation of federal law. This tape is not for resale.



This product is for use with Priority Mail® shipments. Misuse may be a violation of federal law. This tape is not for resale.



This product is for use with Priority Mail® shipments. Misuse may be a violation of federal law. This tape is not for resale.



Visit us at usps.com

Visit us at usps.com

Visit us at usps.com

Label 106A, May 2008

Label 106A, May 2008

Label 106A, May 2008

Mail bearing stamp postage inside the mailer must be canceled by U.S. Postal Service prior to inserting into mailer.

HOW TO USE:

1. Place pre-addressed envelope inside this Priority Mail mailer.
 - Make sure the address shows through the window
 - Any postage placed on the envelope must appear in the window area
 - Any postage applied to the envelope must be canceled by a USPS employee
2. Affix (appropriate) Priority Mail postage or meter strip to the front of the Priority Mail mailer
3. Seal flap on Priority Mail mailer envelope

PHOENIX, ARIZONA
2017 AUG - 2 P 3:13
RECEIVED
BLM AZ STATE OFFICE

EP-14 H April 2000

United States Department of the Interior
Bureau of Land Management
DIV OF LANDS, MINRLS & ENERGY
ONE N CENTRAL AVE
PHOENIX, AZ 85004 -4427
Phone: 602-417-9200

Receipt

No: 3919200

Transaction #: 4028684	
Date of Transaction: 08/03/2017	
CUSTOMER:	
	CLIVE BAILEY PO BOX 385 DRAGOON, AZ 85609-0385 US

LINE #	QTY	DESCRIPTION	REMARKS	UNIT PRICE	TOTAL
1	1.00	LOCATABLE MINERALS / MINING CLAIMS- NOT NEW-UNADJUD, ONE AUTH NO. ONLY / MINING CLAIM MONEY RECEIVED CASES: AMC415596/\$775.00	MAINT FEE 2018 (5)	- n/a -	775.00
TOTAL:					\$775.00

PAYMENT INFORMATION				
1	AMOUNT:	775.00	POSTMARKED:	N/A
	TYPE:	CHECK	RECEIVED:	08/03/2017
	CHECK NO:	1168		
	NAME:	BAILEY, CLIVE PO BOX 385 DRAGOON AZ 85609-0385 US		

REMARKS

This receipt was generated by the automated BLM Collections and Billing System and is a paper representation of a portion of the official electronic record contained therein.

415596

Maintenance Fee

NOTICE OF INTENTION TO HOLD MINING CLAIMS/SITES

When Recorded Return Document to:

Clive Bailey

P.O. Box 385

Draoon, AZ 85609

BLM
Date
StampRECEIVED
BLM AZ STATE OFFICE
2016 AUG 12 P 3:08
PHOENIX, ARIZONA☐ Check here if this is a change of address.

Telephone: _____

E-mail Address: edge49tos@gmail.com

I (We) intend to hold the claims(s) and/or site(s) listed below for the calendar year 2017, and I (We) have filed or will file a Notice of Intent to Hold in the county where the claim (s) is located.

Reason for filing a Notice of Intent to Hold instead of an assessment work filing (check one):

- ☒ Maintenance fee was paid to maintain claim(s) during this assessment year.
- ☐ Mill or tunnel sites.
- ☐ Claim(s) was located during the current assessment year.
- ☐ BLM has deferred assessment work (attach copy of decision granting deferment, or pending petition for deferment including date petition was filed.)

Line No.	AMC NUMBER	CLAIM/SITE NAME	COUNTY RECORDER DATA (If available)	TWP	RNG	SEC
1	415596	Blackwatch fraction	2012-10607	16 S	22 E	13
2						
3						
4						
5						
6						
7						
8						
9						
10						

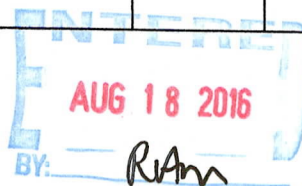

NOTICE OF INTENTION TO HOLD MINING CLAIMS/SITES
page 2

BLM Date Stamp	RECEIVED BLM AZ STATE OFFICE 2016 AUG 12 P 3:00 PHOENIX, ARIZONA
----------------------	---

1. State of Arizona, County of COCHISE
2. I (Name) CLIVE R. G. BAILEY
3. Reside at (Address) PO BOX 385 / 4528 E. SACRED ROCK ROAD
City DRAGON County COCHISE State AZ Zip 85609 being duly sworn, depose and
say that I am a citizen of the United States, more than eighteen years of age, that all of the facts set forth in this
notice, subject to the provisions and penalties of 18 U.S.C. 1001 pertaining to the filing of false, fictitious, or fraudulent
statements with the United States, are true and correct according to the best of my knowledge, information and belief.
4. Owner's name and address (If not shown in Items 1-3 above). _____
5. Dated: 8/10/16 Signature: Clive R. G. Bailey

Bureau of Land Management
Arizona State Office
www.blm.gov/az

No. of Claims:	<u>1</u>	x \$10 =	<u>10</u>
Check No:	<u>1075</u>	Init.	<u>JMC</u>
Receipt No.:	<u>363075</u>		
For BLM Use Only			

Form: MCF110
Revised July 2014
Page 2 of 2

CERTIFIED MAIL®

7016 0910 0002 0488 5432



1000



85004

U.S. POSTAGE
PAID
BENSON, AZ
85602
AUG 10, 16
AMOUNT

\$4.24

R2304Y122730-15

PHOENIX, ARIZONA

2016 AUG 12 P 3 00

RECEIVED
BLMAZ STATE OFFICE

Bureau of Land Management
Arizona State Office
One North Central Avenue, Suite 800
Phoenix, AZ 85004-4427

PLACE STICKER AT TOP OF ENVELOPE TO THE RIGHT
OF THE RETURN ADDRESS. FOLD AT DOTTED LINE

7016 0910 0002 0488 5432

United States Department of the Interior
Bureau of Land Management
DIV OF LANDS, MINRLS & ENERGY
ONE N CENTRAL AVE
PHOENIX, AZ 85004 -4427
Phone: 602-417-9200

Receipt

No: 3630175

Transaction #: 3733961	
Date of Transaction: 08/15/2016	
CUSTOMER:	
	CLIVE BAILEY PO BOX 385 DRAGON, AZ 85609-0385 US

LINE #	QTY	DESCRIPTION	REMARKS	UNIT PRICE	TOTAL
1	1.00	LOCATABLE MINERALS / MINING CLAIMS- NOT NEW-UNADJUD, ONE AUTH NO. ONLY / MINING CLAIM MONEY RECEIVED CASES: AMC415596/\$155.00	NOI 2016/1	- n/a -	155.00
TOTAL:					\$155.00

PAYMENT INFORMATION				
1	AMOUNT:	155.00	POSTMARKED:	08/10/2016
	TYPE:	CHECK	RECEIVED:	08/12/2016
	CHECK NO:	1075		
	NAME:	BAILEY, SHIRLEY M PO BOX 385 DRAGON AZ 85609-0385 US		

REMARKS

This receipt was generated by the automated BLM Collections and Billing System and is a paper representation of a portion of the official electronic record contained therein.

415596

MAINTENANCE FEE PAYMENTClaimant Name: Clive R. G. BaileyAddress: P.O. Box 385City: Dragoon State: AZ Zip: 85609Telephone: (520) 586-2408E-mail address: edgeconsulting49@msn.comSignature: Clive R. G. Bailey

BLM RECEIVED
Date BLM AZ STATE OFFICE
Stamp
2015 AUG 14 P 2:33
PHOENIX, ARIZONA

☐ Check here if this is a change of address.

LINE NO.	AMC NUMBER	CLAIM/SITE NAME	COUNTY RECORDER DATA (If available)	TWP	RNG	SEC
1	415596	Blackwatch fraction	2012-10 607	16S	22E	13
2						
3						
4						
5						
6						
7						
8						
9						
10						

List additional claims on Form MCF114.

Bureau of Land Management
Arizona State Office
www.blm.gov/az/

No. of Claims*: 1 x \$155 = \$155.00Check No: 2546 Init. DAReceipt No.: 3368434

For BLM Use Only

* \$155 per lode mining claim, mill site, or tunnel site; and \$155 for each 20 acres or portion thereof for each placer mining claim.

Form: MCF112
Revised July 2014

This form is available from the **Arizona Geological Survey** and may be reproduced.

ENTERED
AUG 20 2015
BY: RS

ENTERED
AUG 20 2015
BY: RS

P.O. BOX 385
Dragoon, AZ 85609



7015 1660 0000 6685 6164



1000

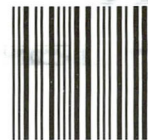

85004

U.S. POSTAGE
PAID
BENSON, AZ
85602
AUG 12, 15
AMOUNT

\$4.16

R2304W121761-16

United States Department of the Interior
Bureau of Land Management
LANDS/RECREATION & PLANNING
ONE N CENTRAL AVE
PHOENIX, AZ 85004 -2203
Phone: 602-417-9200

MINE CLAIMS GROUP

85004441453



CERTIFIED MAIL®

PLACE STICKER AT TOP OF ENVELOPE TO THE RIGHT
OF THE RETURN ADDRESS, FOLD AT DOTTED LINE

7015 1660 0000 0997 5702



United States Department of the Interior
Bureau of Land Management
 LANDS/RECREATION & PLANNING
 ONE N CENTRAL AVE
 PHOENIX, AZ 85004 -2203
 Phone: 602-417-9200

Receipt

No: 3368434

Transaction #: 3466528	
Date of Transaction: 08/17/2015	
CUSTOMER:	
	CLIVE BAILEY PO BOX 385 DRAGOON, AZ 85609-0385 US

LINE #	QTY	DESCRIPTION	REMARKS	UNIT PRICE	TOTAL
1	1.00	LOCATABLE MINERALS / MINING CLAIMS- NOT NEW-UNADJUD, ONE AUTH NO. ONLY / MINING CLAIM MONEY RECEIVED CASES: AMC415596/\$155.00	MAINT FEE PYMNT (1) 2016	- n/a -	155.00
TOTAL:					\$155.00

PAYMENT INFORMATION			
1	AMOUNT:	155.00	POSTMARKED: 08/12/2015
	TYPE:	CHECK	RECEIVED: 08/14/2015
	CHECK NO:	2546	
	NAME:	BAILEY, CLIVE RG PO BOX 385 DRAGOON AZ 85609-0385 US	

REMARKS

This receipt was generated by the automated BLM Collections and Billing System and is a paper representation of a portion of the official electronic record contained therein.

8/17/2015

RECEIPT # 3107825

P.O. Box 385
Dragoon, AZ 85609

PHOENIX AZ 852

19 AUG 2014 PM 10:11

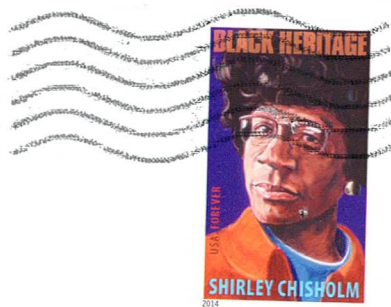

RECEIVED
BLM AZ STATE OFFICE

2014 AUG 20 P 1:56

PHOENIX, ARIZONA

Bureau of Land Management
Arizona State Office
One North Central Ave.
Suite 800
Phoenix, AZ 85004-4427

85004442700



United States Department of the Interior
Bureau of Land Management
 LANDS/RECREATION & PLANNING
 ONE N CENTRAL AVE
 PHOENIX, AZ 85004 -2203
 Phone: 602-417-9200

Receipt

No: 3107825

Transaction #: 3199480		ENTERED INTO COMPUTER
Date of Transaction: 08/21/2014		
CUSTOMER:		AUG 25 2014 <i>JB</i>
CLIVE BAILEY PO BOX 385 DRAGON, AZ 85609-0385 US		

LINE #	QTY	DESCRIPTION	REMARKS	UNIT PRICE	TOTAL
1	1.00	LOCATABLE MINERALS / MINING CLAIMS- NOT NEW-UNADJUD, ONE AUTH NO. ONLY / MINING CLAIM MONEY RECEIVED CASES: AMC415596/\$155.00	MAINT FEE PYMNT (1) 2015	- n/a -	155.00
TOTAL:					\$155.00

PAYMENT INFORMATION			
1	AMOUNT:	155.00	POSTMARKED: 08/19/2014
	TYPE:	CHECK	RECEIVED: 08/20/2014
	CHECK NO:	1633	
	NAME:	BAILEY, CLIVE PO BOX 385 DRAGON AZ 85609-0385 US	

REMARKS

This receipt was generated by the automated BLM Collections and Billing System and is a paper representation of a portion of the official electronic record contained therein.

UNITED STATES
DEPARTMENT OF THE INTERIOR
BUREAU OF LAND MANAGEMENT
**MAINTENANCE FEE PAYMENT FORM FOR
LODE CLAIMS, MILL SITES, AND TUNNEL SITES**

AMC 415596

Remitter Name: Clive R. G. Bailey
Mailing Address: P.O. Box 385
City, State, Zip: Dragoon, AZ 85609

☐ Check here if this is a change of address.

RECEIVED
BLM AZ STATE OFFICE
2013 AUG 22 P 3:04
PHOENIX, ARIZONA

FOR COUNTY RECORDER'S USE

No. of claims/sites 1
x \$140 per claim/site
Total due BLM \$ 140

1. The maintenance fee may be paid by cash, check, money order, Bureau of Land Management (BLM) Declining Deposit Account, or credit card (VISA, American Express, Discover, or MasterCard). Payments must be remitted to the BLM State Office where your claim or site is recorded and received on or before September 1. If the payment is mailed, the envelope must be postmarked by a bona fide delivery service on or before September 1 and received at the proper BLM State Office within 15 calendar days after the due date. Payments may also be made by telephone using a credit card. A complete listing of BLM State Offices with their addresses and phone numbers can be found at <http://www.blm.gov>.
2. The maintenance fee for the following claim(s)/site(s) applies to the assessment year 2013.

CLAIM/SITE NAME	BLM SERIAL NO.
BLACKWATCH FRACTION	AMC 415596

ENTERED
AUG 28 2013
BY: TS

Use a separate sheet for additional claim/site names, serial numbers, and claimant names and addresses.

(Continued on page 2)

2862637

UNITED STATES
DEPARTMENT OF THE INTERIOR
BUREAU OF LAND MANAGEMENT
**MAINTENANCE FEE PAYMENT FORM FOR
LODE CLAIMS, MILL SITES, AND TUNNEL SITES**

Amc 415596

Remitter Name: Clive R. G. Bailey
Mailing Address: P.O. Box 385
City, State, Zip: Dragoon, AZ 85609

☐ Check here if this is a change of address.

FOR COUNTY RECORDER'S USE

No. of claims/sites 1
x \$140 per claim/site
Total due BLM \$ 140 - *Ad*

1. The maintenance fee may be paid by cash, check, money order, Bureau of Land Management (BLM) Declining Deposit Account, or credit card (VISA, American Express, Discover, or MasterCard). Payments must be remitted to the BLM State Office where your claim or site is recorded and received on or before September 1. If the payment is mailed, the envelope must be postmarked by a bona fide delivery service on or before September 1 and received at the proper BLM State Office within 15 calendar days after the due date. Payments may also be made by telephone using a credit card. A complete listing of BLM State Offices with their addresses and phone numbers can be found at <http://www.blm.gov>.
2. The maintenance fee for the following claim(s)/site(s) applies to the assessment year 2012.

CLAIM/SITE NAME	BLM SERIAL NO.
BLACK WATCH FRACTION	AMC 415596

Use a separate sheet for additional claim/site names, serial numbers, and claimant names and addresses.

(Continued on page 2)

ENTERED INTO COMPUTER

9/8/12 AT

NOTICE!!

These documents have been scanned!

Do not place un-scanned documents beneath this notice!

Do not remove this notice from this file!

GPO Jacket No. 560-102
Print Order 61540
Rise Business Services, LLC
Job=AZ15 5/14/2019



Box Number= AZ15047



Claim Begin-End: AMC415596-AMC415596

6 Location Notices-Amendments and Supporting Documents



AZ15047-2

AMC415557-AMC416189

MINING CLAIM STATUS REPORT

DATA
ENTERED

MAY 03 2012 *JB*

MTP Checked by *SC*

GEO Checked by *SC*

LEAD SERIAL NUMBER

AMC

415596

thru

AMC

OF CLAIMS & TYPE

1 LODE
_____ PLACER
_____ ASSOCIATION PLACER
_____ MILL SITE
_____ TUNNEL SITE

CHARGES

Location Fee @ \$34 = \$ 34

Processing Fee @ \$15 = \$ 15

Maintenance Fee @ \$140 = \$ 140

Overage (+) \$ _____

Shortage (-) \$ _____

Other Fees \$ _____

TOTAL \$ 189

ARE THERE ENOUGH LOCATORS?

Yes () No (X) _____

DOCUMENTS RECEIVED VIA -

Over-the-Counter (X) Mail ()

TIMELY FILED?

Yes (X) No ()

LEGAL DESCRIPTION -

T 16S R 22E SEC 13
T _____ R _____ SEC _____
T _____ R _____ SEC _____
T _____ R _____ SEC _____

BLM (X) FOREST SERVICE () _____ SUBJ TO PL 359: Yes () No ()

WILDERNESS AREA: No () Yes () _____

SPLIT ESTATE - N/A () SX () PX () SRHA () OTHER () _____

Proper Notice Filed if Located on SHRA Lands? N/A () Yes () No ()

RECONVEYED MINERALS ON BLM LANDS REQUIRE OPENING ORDERS FROM 1944 TO 1993 -

Open to Entry on: _____ N/A ()

COMMENTS/STATUS - VOID () PARTIALLY VOID () PVT MINERALS () WITHDRAWN LANDS ()

OTHER () _____

Claimant acknowledges that portions of the following claims(s) site(s) may be void or voidable.

Printed Name of Claimant _____

Signature of Claimant _____

***** FINAL ADJUDICATION *****

DATE 5/30/2012 INITIALS JS

AMC415595

ARIZONA NOTICE OF LODGE MINING CLAIM LOCATION

Having complied with the requirements of Title 30, U.S. Code, Section 28, and the local laws, customs, and regulations of this State, I on the 27th day of April 2012, locate the **Blackwatch Fraction** Mining Claim upon a valuable mineral deposit containing **copper** and other locatable minerals in a vein or lode situated in the **Cochise Mining District, Cochise County, State of Arizona.**

Said claim is described as follows and is marked on the ground with seven posts and a copy of this Notice is posted in a conspicuous place thereon at the (LM) Said claim is a polygon (rectangular at the south base truncated by two Patented claims to the north at angles). This claim fraction has concurrent boundaries with the Marguerite MS#2842A (NW) and the MT Allen MS#2842A (NE) & Tam-O-Shanter MS#288 to the south. The general extent is feet in length (N-S) and 600 feet in width (E-W). Its length is along the lode or vein in a north to south direction. The **location monument** is posted **100 feet North of South End Center,**

Said claim is in the:

Quarter	Section	Township	Range
NW	13	16S	22 E ^{MB}

GSRB&M Prime Meridian and is more particularly described as follows:

Corners and Location Monument are marked on the ground by 4' long wooden posts as follows: The **Location Monument** of the **Blackwatch Fraction** is located ~1010 feet S 63°W of the NW section corner of Section 13, T16S, R22E, GSRB&M, thence 100 feet South to The **South End Center** then 300 feet N87°44'E to SE corner (along the mutual boundary of the Tam-O-Shanter (MS#288) patent, then ~220 feet north to NW Corner, then ~400 feet N38°10' W along the Patent boundary of the MT Allen (MS 2842A) to a point intersect with the E-W section line 12&13, thence ~50 West then to the **North End Center**, then ~250 feet S41°29'W to the SW corner of the Marguerite MS#2842A Patented claim, then ~182 feet N 48°31'W 170' both along the Patent boundaries of the Marguerite to the NW corner, then ~500 feet south to SW corner then 300 feet N87°44'E along the mutual boundary of the Tam-O-Shanter (MS#288) patent back to the **South End Center.**

Located by:

Cl. R. G. Bailey (Signed) Clive R. G. Bailey (printed)

Witness:

Shirley M. Bailey (Signed) Shirley M. Bailey (printed)

Clive R. G. Bailey
P.O. Box 385
Dragoon, Arizona 85609

COUNTY RECORDATION:

RECEIVED
B.L.M. AZ STATE OFFICE
2012 APR 30 A 11:02
PHOENIX, AZ

AMC415596

13

7 12

13

S 75° 52' E
750'

N32° 28' 38" W
686.73

-563 E- 1010'

NW 1/4 MS MARGUERITE
2842 A
N 48.31 W
132'

541° 24' W ~ 50°
250° NEC
N 560°

MT ALLEN
N5 2842A
N400 N39°

BLACK WATCH FRACTION

NE 0 N38°10'W

232

300' SEC 300'
N 87° 44' E 980'

TAM. O SHANTER
MS 288

S 87° 44' W 1355'

UN-PATENTED
ALPHA - 128

UN-PAT
ALPHA-129

UN-PAT
ALPHA-130

0 100 200 300 400 500 600

FEET

SECTION 13 TOWNSHIP 16S

G. + S. R. B. + M

RANGE 22

PHOENIX, AZ

2012 APR 30 A 11:02

RECEIVED
B.L.M. AZ STATE OFFICE

ANC 1-5596

SEC CORNER
12

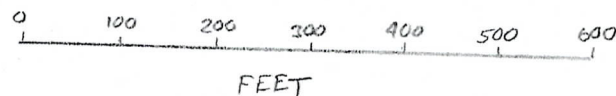

RANGE 28
PHOENIX, AZ

2017 APR 30 A 11:02

RECEIVED
B.L.M. AZ STATE OFFICE

ALIC 15596

NE 1/4, T. 16 S., R. 22 E.
COCHISE DIST.

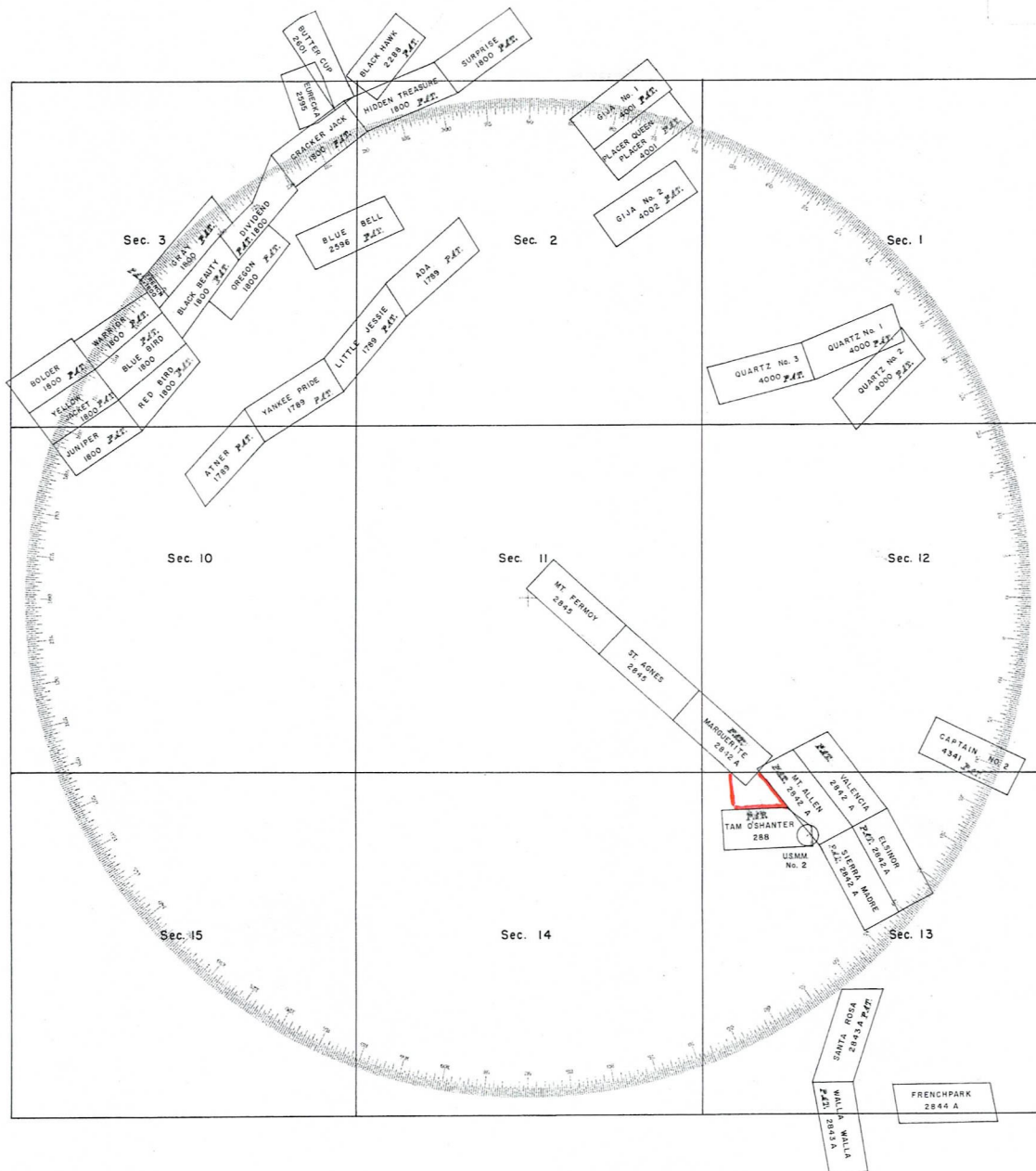

Black Watch Fraction

Input Parameters for Geographic Report with Land

System Id = CR

Admin State = AZ

Geo State =

Casetype Begins With

Case Disp Txt = AUTHORIZED, CANCELLED, EXPIRED, PENDING, REJECTED, RELINQUISHED, VOID, WITHDRAWN

Mer Twp Rng = 14 0160S 0220W

Section = 013, 999

Mtrs =

Commodity =

Commodity Txt =

Pending Org =

Pend Org Decode =

Total Rows Returned: 0

STATUS OF PUBLIC DOMAIN
LAND AND MINERAL TITLES[illegible]

DIST. NO. 4

MDS	773	NE
	774	SE

PHX 083572 R/W 20'

Sec 13 Lot 7 M & B

A 22287 R/W 7.5'
Sec 5: SE1/4

AZA 30099 R/W 20'
Sec 1: SW1/4SE1/4
Sec 13: Lot 7

- claim boundary

[illegible]

T. 16S
R. 22E

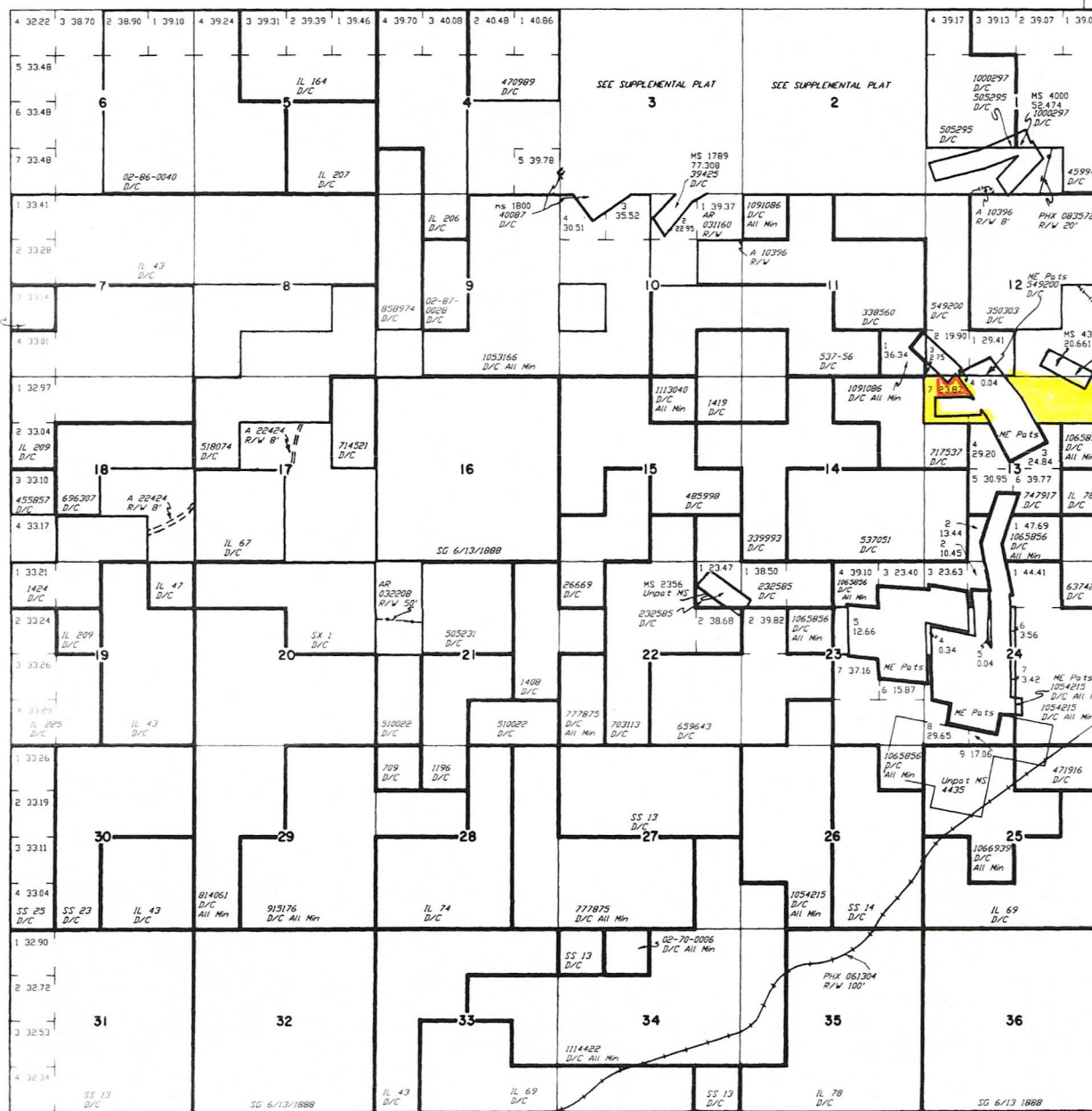

SCALE

10 20 30 60

30 chains to the inch

WARNING STATEMENT
This plat is the Bureau's Record of Title, and should be used only as a graphic display of the township survey data. Records hereon do not reflect title changes which may have been effected by lateral movements of rivers or other bodies of water. Refer to the cadastral surveys for official survey information.